

Schnitt "C - C"

M 1:15

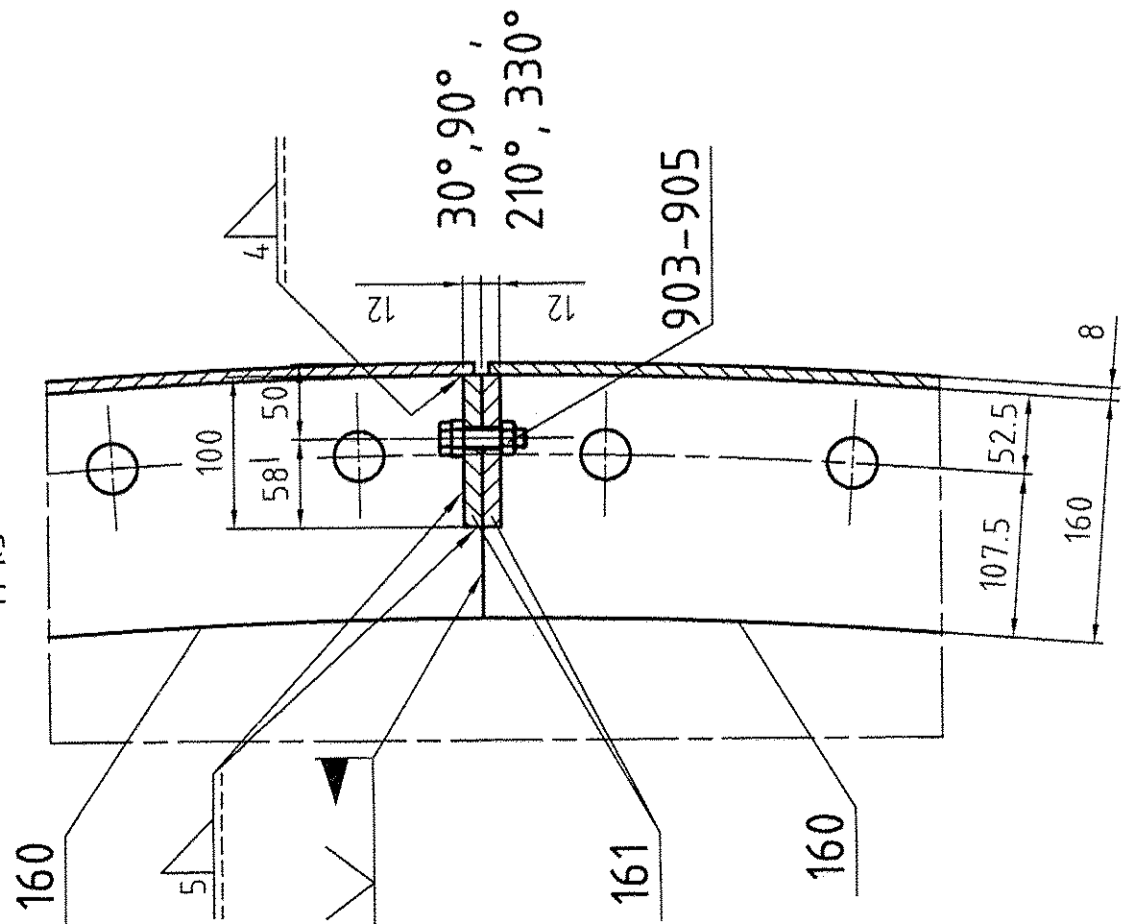

Detail "X"

M 1:5

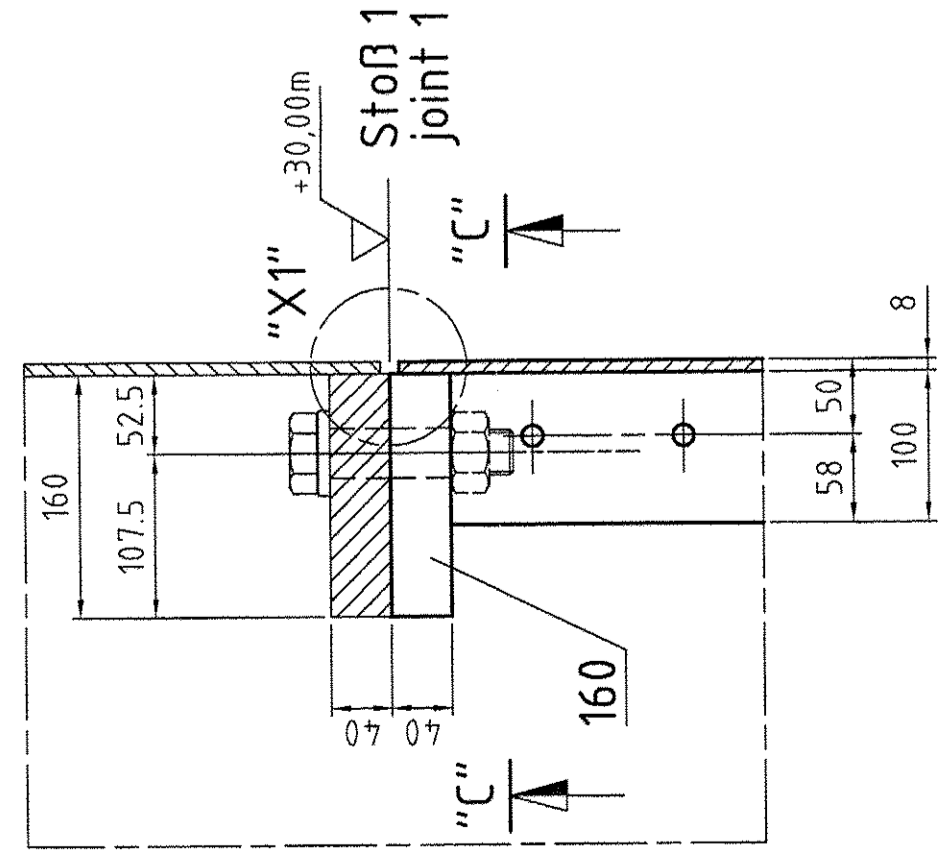

Detail "X1"

M 1:1

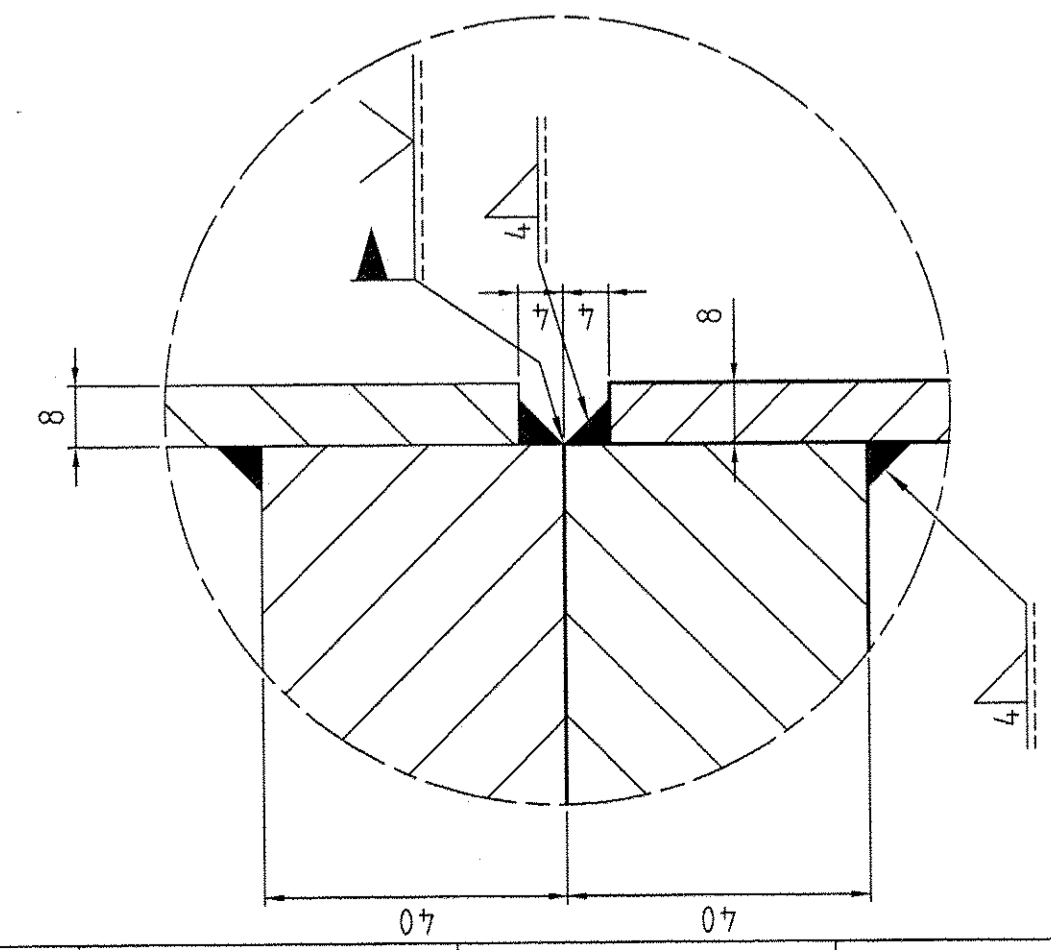

Detail Pos. 161

M 1:10

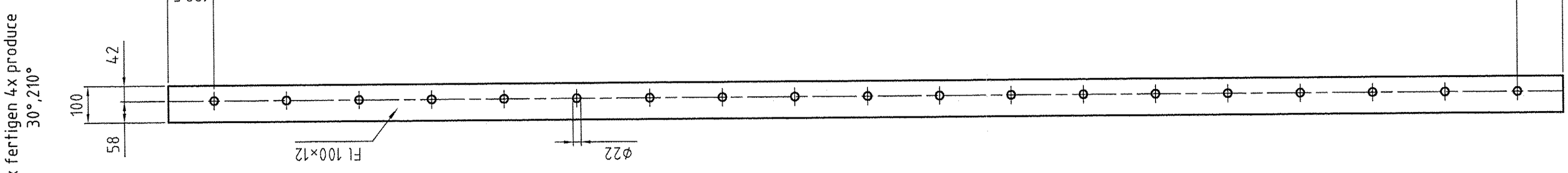

Pos./item 160

M 1:20

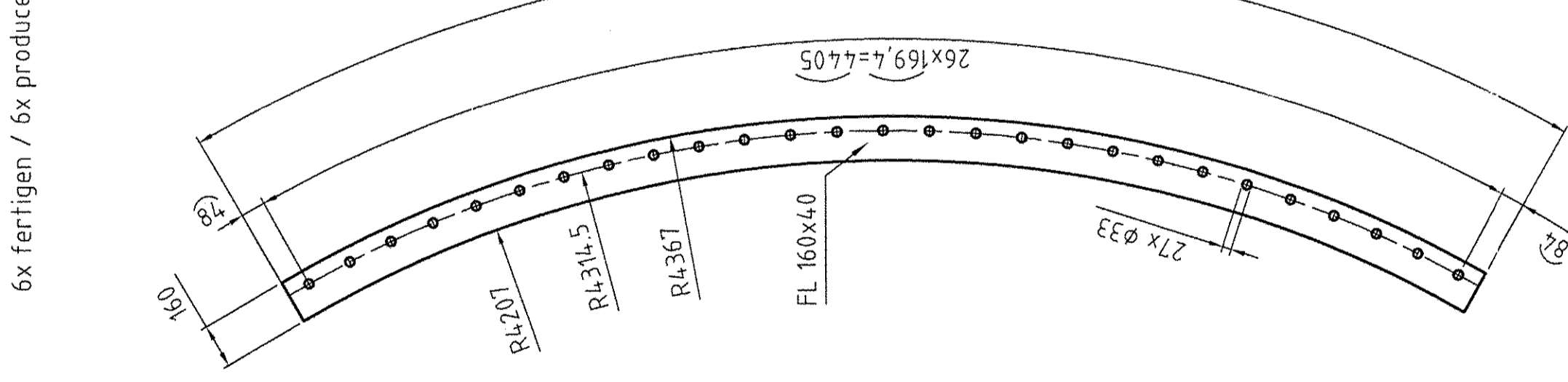

Pos./item 162

M 1:20

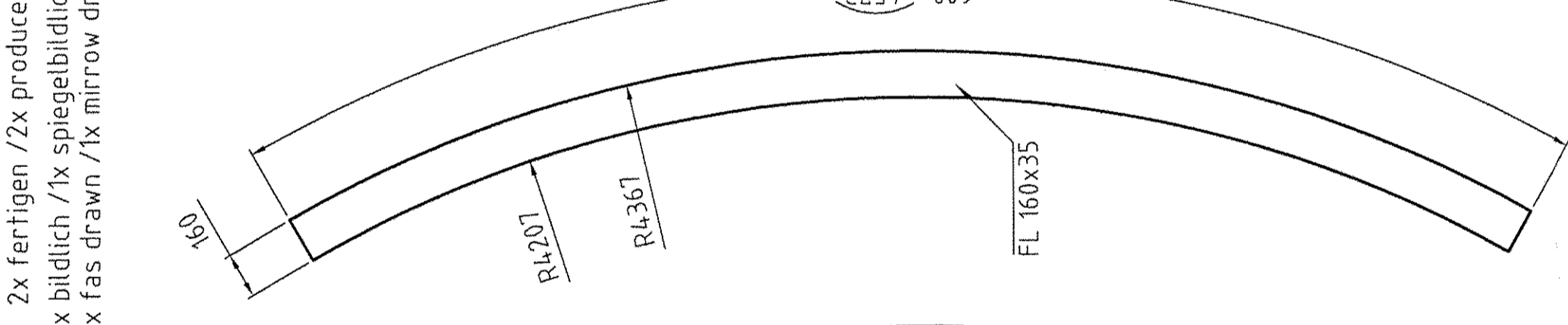

Pos./item 172

M 1:20

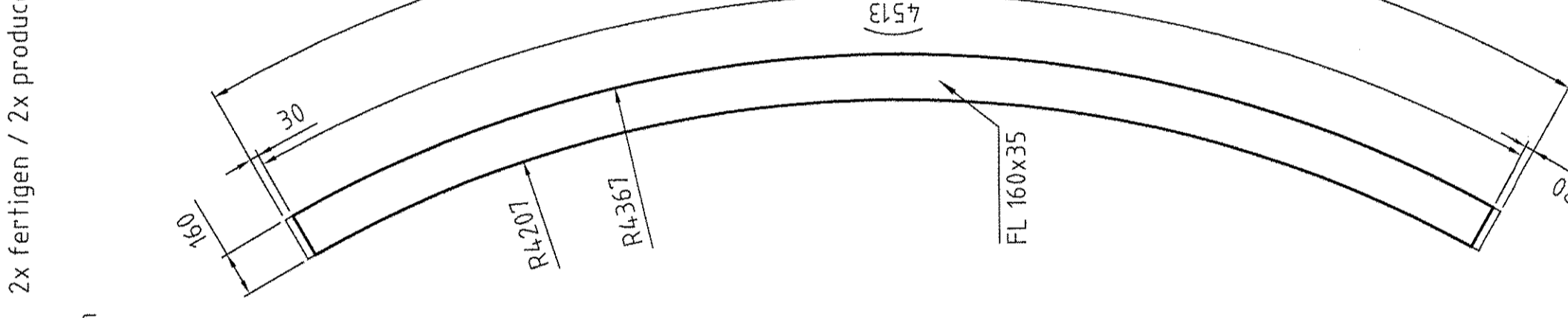

Pos./item 176

M 1:20

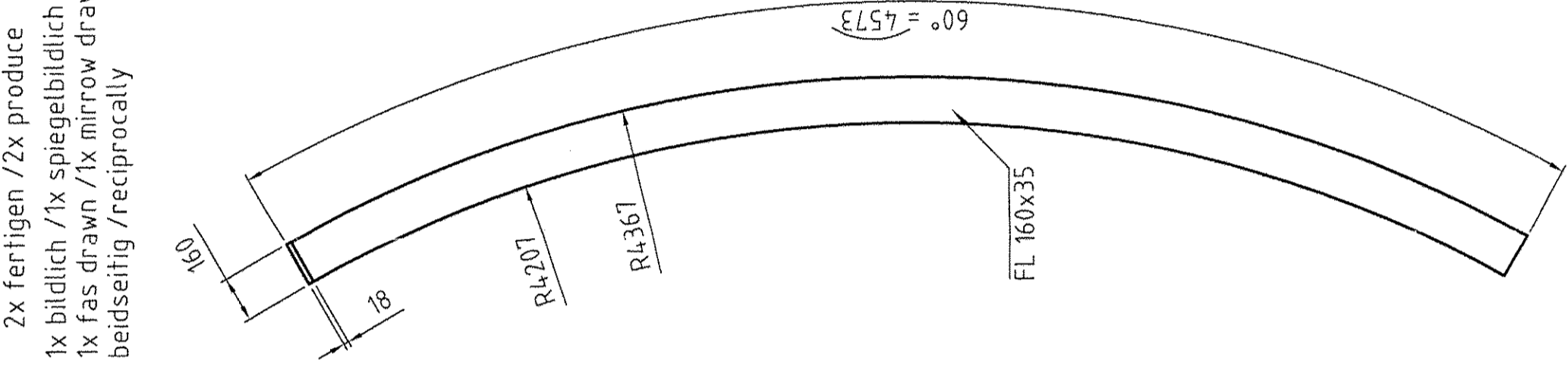

Schnitt A1-A1/ section A1-A1

M 1:1

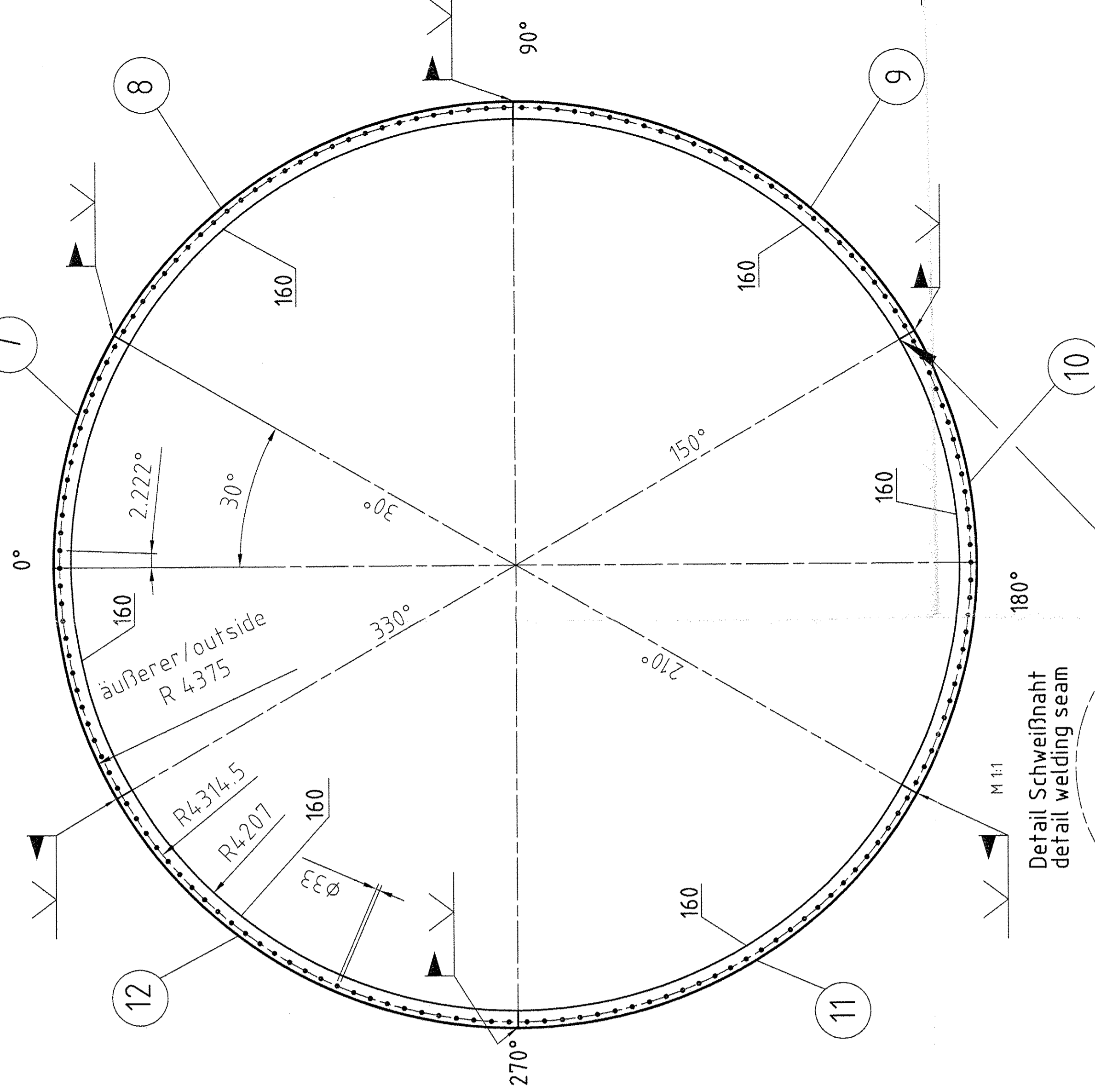

Detail Schweißnaht detail welding seam

M 1:1

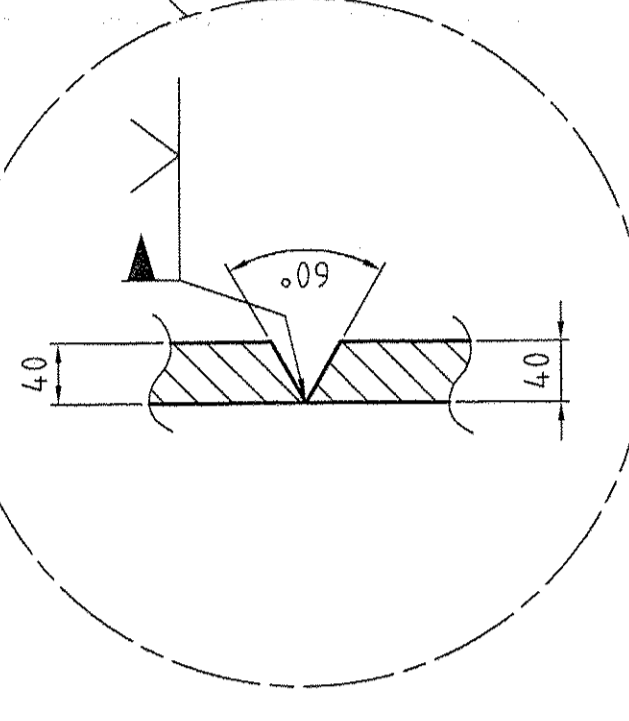

Pos./item 174

M 1:10

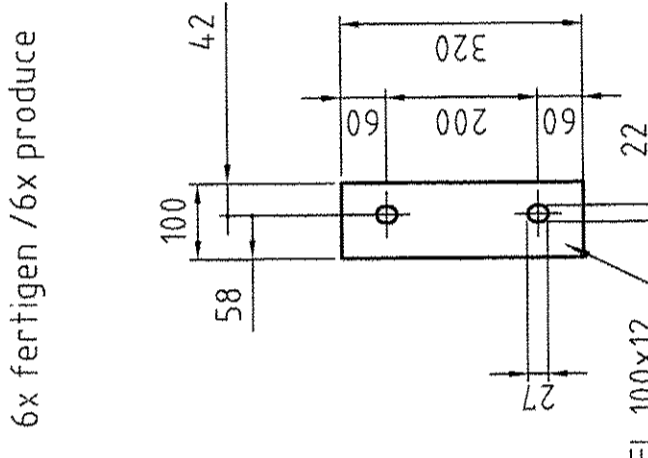

Pos./item 175

M 1:10

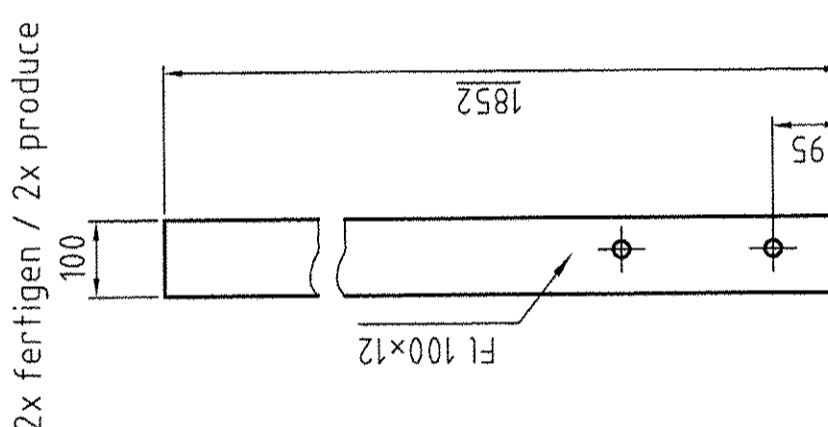

Pos./item 173

M 1:10

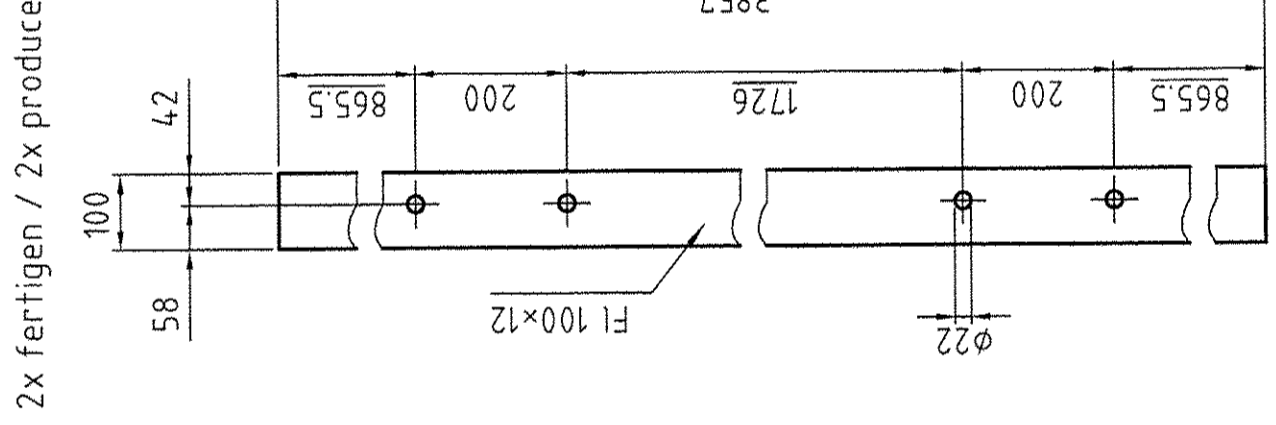

Detail Pos. 163

M 1:10

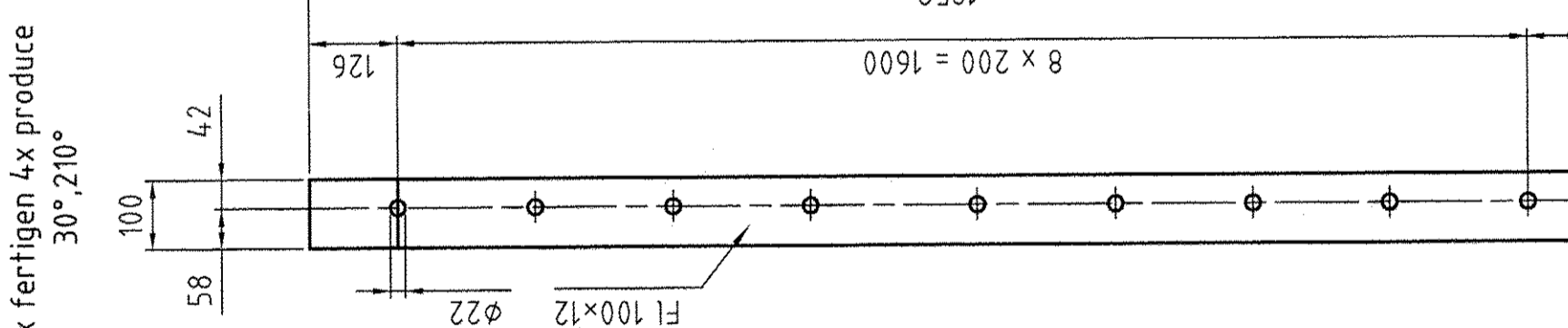

Zeichnung gehört zu: Drawing belongs to: 05-101-404

Hierzu gehört Zeichnung: 05-101-400-403;05-101-405-415 See also drawing:

Werkstoff:	Werkstückarten:	Maßstab:	Algemeintoleranzen:	Alle mit Sauerstoff in Berührung kommenden Teile öl- und fettfrei
ISO-Methode E	Datum:	Name:	Gepr.:	Norm:
Bezug / Projekt: K70101 ASU No. 9 Kosice				
Benennung: Coldbox (Pos. 7-12) +24,00m to +30,00m				
Blatt-Nr.: Blattzahl: F Z				
HISTORY FILE: 05-101-404-0-d.dwg				
SCALE: 1:33 1/3 ORIGINAL FORMAT: DIN A1				
SHEET: 2 OF 2 SHEETS				
DRAWING No.: 05-101-404				
REV. 0				

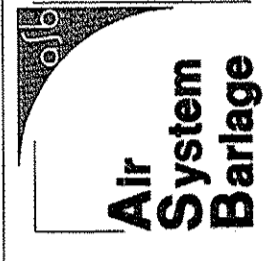

Air System Barlage

REPLACES: DATE: 14.04.05

REPLACED BY: DATE: 14.04.05

REPLACES: DATE: 14.04.05

REPLACED BY: DATE: 14.04.05